

Application: metal and not metal sheets.  
Assembly: with special hand or pneumatic tools.

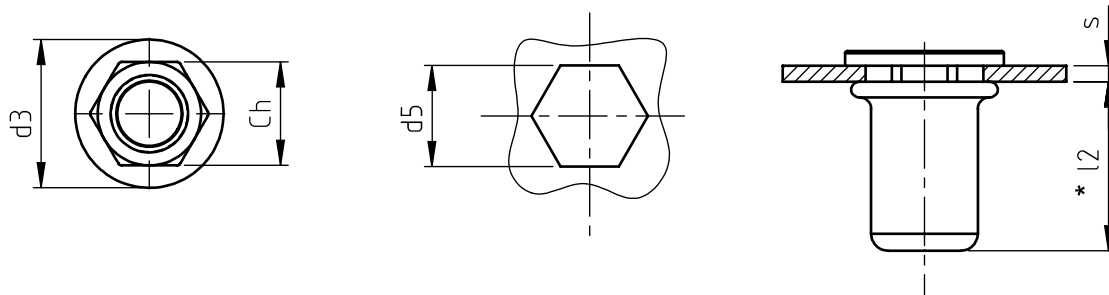

Picture A

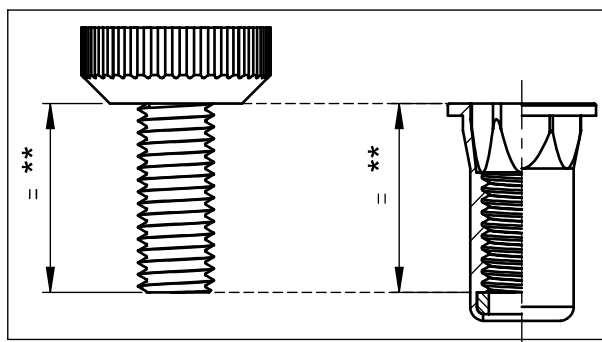

| code           | s         | l<br>+0,50<br>-0,50 | d1<br>6H | ch | d3 | l1  | d5<br>+0,15<br>0 | l2<br>* |
|----------------|-----------|---------------------|----------|----|----|-----|------------------|---------|
| ETC/A M 5/8S   | 0,5 ÷ 2,5 | 14,0                | M 5      | 7  | 10 | 1,0 | 7                | 12      |
| ETC/A/L M 5/8S | 2,5 ÷ 4,5 | 16,0                |          |    |    |     |                  |         |
| ETC/A M 6/8S   | 0,5 ÷ 3,0 | 18,0                | M 6      | 9  | 12 | 1,2 | 9                | 15      |
| ETC/A/L M 6/8S | 3,0 ÷ 5,5 | 20,5                |          |    |    |     |                  |         |
| ETC/A M 8/8S   | 0,5 ÷ 3,5 | 19,0                | M 8      | 11 | 14 | 1,3 | 11               | 15      |
| ETC/A/L M 8/8S | 3,5 ÷ 6,0 | 21,5                |          |    |    |     |                  |         |
| ETC/A M10/8S   | 0,5 ÷ 3,5 | 25,0                | M10      | 13 | 17 | 1,7 | 13               | 18      |
| ETC/A/L M10/8S | 3,5 ÷ 6,0 | 27,5                |          |    |    |     |                  |         |

Non binding dimensions, expressed in mm.

\* Dimension determined from the average of the grip "s" min and max values.

\*\* The insert has to be screwed on the mandrel for the whole threaded lenght, avoiding the screw into the nylon washer as highlighted in the picture (A) above.



Standard



On demand



Not manufactured

Material: rivet steel no.10303  
washer nylon  
Finishing: rivet zinc-plated  
washer natural  
Thread: ISO 6 H metric  
Example: thread tubular self-locking rivet nut,  
round head, semi-hexagonal shank, steel,  
grip 3,0 mm, M 8 thread: ETC/A M 8/8S

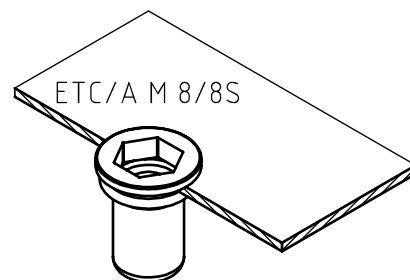

Application: metal and not metal sheets.  
Assembly: with special hand or pneumatic tools.

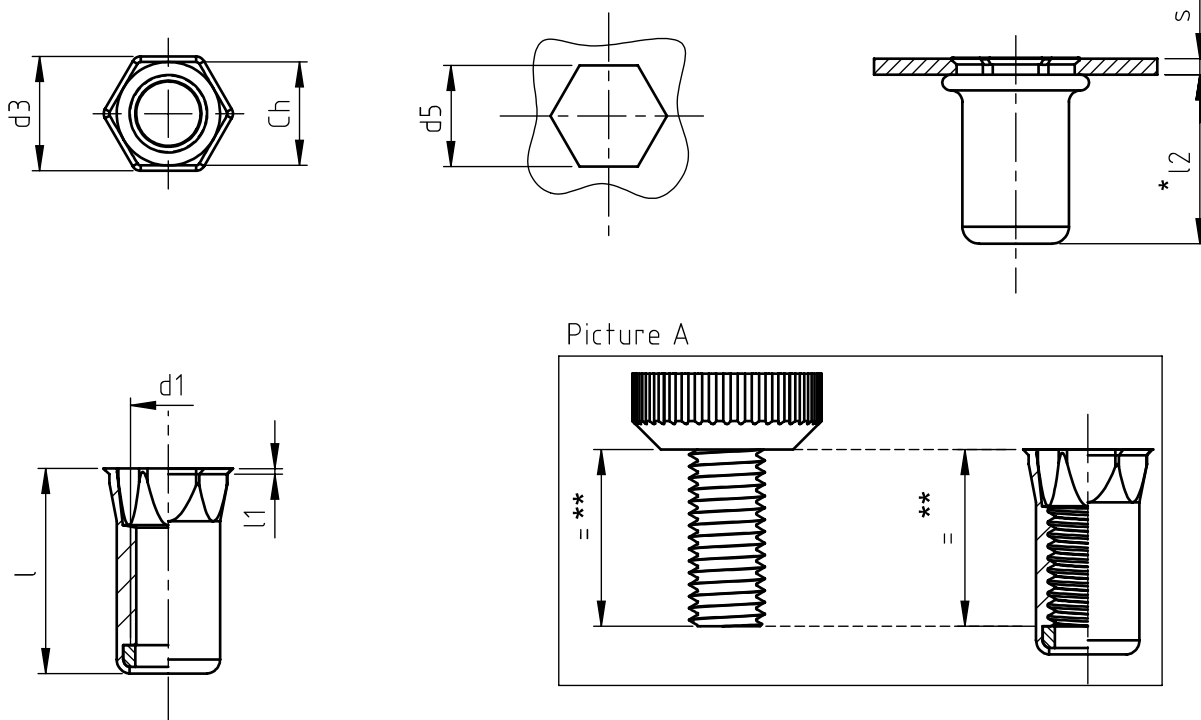

| code            | s         | $\begin{matrix} l \\ +0,50 \\ -0,50 \end{matrix}$ | $\begin{matrix} d1 \\ 6H \end{matrix}$ | ch | d3   | $\begin{matrix} l1 \\ \sim \end{matrix}$ | $\begin{matrix} d5 \\ +0,15 \\ 0 \end{matrix}$ | $\begin{matrix} l2 \\ * \end{matrix}$ |
|-----------------|-----------|---|--|----|------|--|--|---------------------------------------|
| ETFM/A M 5/8S   | 0,5 ÷ 2,5 | 14,0  | M 5                                    | 7  | 8    | 0,6                                      | 7  | 12                                    |
| ETFM/A/L M 5/8S | 2,5 ÷ 4,5 | 16,0  |  |    |      |  |  |                                       |
| ETFM/A M 6/8S   | 0,5 ÷ 3,0 | 17,0  | M 6                                    | 9  | 10   | 0,7                                      | 9  | 15                                    |
| ETFM/A/L M 6/8S | 3,0 ÷ 5,5 | 19,5  |  |    |      |  |  |                                       |
| ETFM/A M 8/8S   | 0,5 ÷ 3,5 | 19,0  | M 8                                    | 11 | 12   | 0,8                                      | 11   | 15                                    |
| ETFM/A/L M 8/8S | 3,5 ÷ 6,0 | 21,5  |  |    |      |  |  |                                       |
| ETFM/A M10/8S   | 0,5 ÷ 3,5 | 24,5  | M10                                    | 13 | 14,5 | 0,9                                      | 13   | 18                                    |
| ETFM/A/L M10/8S | 3,5 ÷ 6,0 | 27,0  |  |    |      |  |  |                                       |

Non binding dimensions, expressed in mm.

\* Dimension determined from the average of the grip "s" min and max values.

\*\* The insert has to be screwed on the mandrel for the whole threaded length, avoiding the screw into the nylon washer as highlighted in the picture (A) above.



Standard



On demand



Not manufactured

Material: blind thread nut steel no.1.0303  
washer nylon  
Finishing: blind thread nut zinc-plated  
washer natural  
Thread: ISO 6 H metric  
Example: thread tubular self-locking rivet nut,  
low profile head, semi-hexagonal shank,  
steel, grip 3,0 mm, M 8 thread: ETFM/A M 8/8S

