

Application: resin, composite materials and other.
Mounting: by adhesive, moulding.

Type T

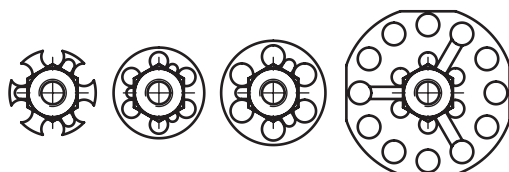

T1900=∅19

T2000=∅20

T2300=∅23

T3800=∅38

Type Q

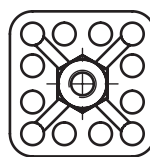

Q3232=32x32

Type R

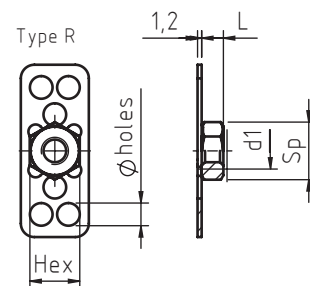

R3815=38x15

| code | thread d1 | Hex | Sp | ∅ holes | L +1,0/-0 |
|------------------|--------------|-----|------|------------|--------------|
| DRP03Q3232040. _ | M 4 | 7 | 7,8 | 5 | 3,2 |
| DRP03T1900040. _ | | | | 5 | |
| DRP03T2000040. _ | | | | 4 | |
| DRP03T2300040. _ | | | | 5 | |
| DRP03T3800040. _ | | | | 5 | |
| DRP03R3815040. _ | M 5 | 8 | 8,9 | 5 | 4 |
| DRP04Q3232050. _ | | | | 5 | |
| DRP04T1900050. _ | | | | 5 | |
| DRP04T2000050. _ | | | | 4 | |
| DRP04T2300050. _ | | | | 5 | |
| DRP04T3800050. _ | M 6 | 10 | 11,1 | 5 | 5 |
| DRP04R3815050. _ | | | | 5 | |
| DRP05Q3232060. _ | | | | 5 | |
| DRP05T1900060. _ | | | | 5 | |
| DRP05T2000060. _ | | | | 4 | |
| DRP05T2300060. _ | M 8 | 13 | 14,4 | 5 | 6,5 |
| DRP05T3800060. _ | | | | 5 | |
| DRP05R3815060. _ | | | | 5 | |
| DRP06Q3232080. _ | | | | 5 | |
| DRP06T1900080. _ | | | | 5 | |
| DRP06T2000080. _ | M 10 | 17 | 19,0 | 4 | 8 |
| DRP06T2300080. _ | | | | 5 | |
| DRP06T3800080. _ | | | | 5 | |
| DRP06R3815080. _ | | | | 5 | |
| DRP08Q3232100. _ | | | | 5 | |
| DRP08T1900100. _ | M 10 | 17 | 19,0 | 5 | 8 |
| DRP08T2000100. _ | | | | 4 | |
| DRP08T2300100. _ | | | | 5 | |
| DRP08T3800100. _ | | | | 5 | |
| DRP08R3815100. _ | | | | 5 | |

N.B.: is available on request
the blind version with
code: DRC _____.

Non binding dimensions, expressed in mm.



Standard



On demand



Not manufactured

Material: steel _____,12, stainless steel AISI 316 L _____,51

Finishing: nuts in steel: zinc coated
nuts in stainless steel AISI 316 L: natural

Tolerance: where not specified, coarse degree of accuracy,
according to ISO 2768-m

Thread: metric ISO 6 H

Example: nut with rectangular plate, M5 thread, length 4 mm,
zinc coated steel: DRP04R3815050.12

